

DRITTO
FLAT

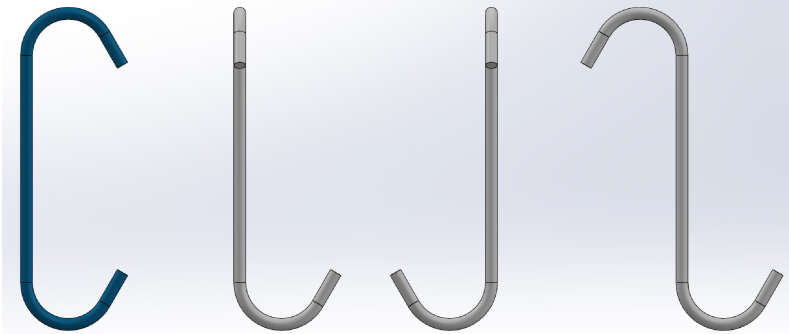

| CODICE CODE | L(mm) |
|----------------|-------|
| D3L50-C | 50 |
| D3L60-C | 60 |
| D3L80-C | 80 |
| D3L100-C | 100 |
| D3L120-C | 120 |
| D3L150-C | 150 |
| D3L180-C | 180 |
| D3L200-C | 200 |
| D3L260-C | 260 |
| D3L300-C | 300 |
| D3L360-C | 360 |
| D3L400-C | 400 |
| D3L500-C | 500 |
| D3L600-C | 600 |
| D3L700-C | 700 |
| D3L800-C | 800 |
| D3L900-C | 900 |
| D3L1000-C | 1000 |

DESCRIZIONE / DESCRIPTION

GANCIO ACCIAIO "EN20170-SM" Ø3, PIEGA STANDARD "C"
STEEL HOOK "EN20170-SM" Ø3, STANDARD BENDING "C"

MATERIALE / MATERIAL

EN10270-SM (C70)



SCALA / SCALE

1:1

FORMATO / SHEET SIZE

A4



Rostirolla s.r.l.